

**PUBLIC PATH EXTINGUISHMENT ORDER  
UNDER THE TOWN AND COUNTRY PLANNING ACT 1990,  
SECTION 258**

**TOWN AND COUNTRY PLANNING ACT 1990  
SECTION 258(1)**

**THE CITY OF SUNDERLAND (CHAPELGARTH) PUBLIC PATH  
EXTINGUISHMENT ORDER 2016**

**PUBLIC PATH EXTINGUISHMENT ORDER  
UNDER THE TOWN AND COUNTRY PLANNING ACT 1990  
SECTION 258**

**TOWN AND COUNTRY PLANNING ACT 1990, SECTION 258(1)**

**THE CITY OF SUNDERLAND (CHAPELGARTH) PUBLIC PATH  
EXTINGUISHMENT ORDER 2016**

This Order is made by the Council of the City of Sunderland under Section 258(1) of the Town and Country Planning Act 1990 which:-

- (a) appropriated for planning purposes the land described in the Schedule to this Order ("the Schedule") which is subject to the public footpaths to which this order relates and such land is held by the authority for the purposes for which it was appropriated; and
- (b) is satisfied that alternative footpaths will be provided

**BY THIS ORDER** the public rights of way over the land being footpaths and shown by a bold black line on the attached order map and described in the Schedule are extinguished at the expiration of 28 days from the date of confirmation of this Order.

**SCHEDULE**

Description of site of paths extinguished

The footpaths to be extinguished are located within the Doxford area of Sunderland City in the County of Tyne & Wear on land which has been appropriated for planning purposes located to the south of Moorside Road and Weymouth Road, Chapelgarth, Sunderland. The footpaths to be extinguished are shown by a continuous bold black line on the attached order map SUO48294/03 and described as follows:

- **Footpath A – B**  
Commencing at point A (OS Ref: 436906, 551994), running in a south-easterly direction for a distance of 214.4 metres to point B (OS Ref: 436996, 551800), a width of 1.2 metres.
- **Footpath C – B – D**  
Commencing at point C (OS Ref: 436980, 551792), running in a north-easterly direction for a distance of 17.6 metres to point B (OS Ref: 436996, 551800), continuing in a north-easterly direction for a distance of 203.5 metres to point D (OS Ref: 437182, 551883), a width of 1.2 metres.

- **Footpath E – F – G**  
 Commencing at point E (OS Ref: 436983, 551781), running in a north-easterly direction for a distance of 226.8 metres to point F (OS Ref: 437189, 551874), continuing in a north-easterly direction for a distance of 34.9 metres to point G (OS Ref: 437222, 551884), a width of 1.2 metres.
- **Footpath H – I – D – F – J – K – L – M – N – O – P**  
 Commencing at point H (OS Ref: 437088, 552059), running in a southerly direction for a distance of 138.9 metres to point I (OS Ref: 437150, 551945), continuing in a southerly direction for a distance of 69.5 metres to point D (OS Ref: 437182, 551883), then south-easterly direction for a distance of 11.6 metres to point F (OS Ref: 437189, 551874), continuing in a south-easterly direction for a distance of 93.6 metres to point J (OS Ref: 437261, 551814), continuing in a south-easterly direction for a distance of 48.3 metres to point K (OS Ref: 437299, 551785), continuing in a south-easterly direction for a distance of 63.2 metres to point L (OS Ref: 437358, 551764), continuing in a south-easterly direction for a distance of 29.8 metres to point M (OS Ref: 437387, 551761), continuing in a south-easterly direction for a distance of 33.7 metres to point N (OS Ref: 437419, 551749), then easterly direction for a distance of 249.3 metres to point O (OS Ref: 437261, 551814), then north-easterly for a distance of 194.6 to point P (OS Ref: 437838, 551846), a width of 1.2 metres.
- **Footpath I – G – Q – R – S**  
 Commencing at point I (OS Ref: 437150, 551945), running in a south-easterly direction for a distance of 98.0 metres to point G (OS Ref: 437222, 551884), continuing in a south-easterly direction for a distance of 34.9 metres to point Q (OS Ref: 437313, 551834), then easterly direction for a distance of 44.8 metres to point R (OS Ref: 437350, 551844), then northerly direction for a distance of 20.2 metres to point S (OS Ref: 437344, 551863), a width of 1.2 metres.
- **Footpath T – Q – K – U**  
 Commencing at point T (OS Ref: 437323, 551873), running in a southerly direction for a distance of 39.7 metres to point Q (OS Ref: 437313, 551834), continuing in a southerly direction for a distance of 50.7 metres to point K (OS Ref: 437299, 551785), continuing in a southerly direction for a distance of 183.2 metres to point U (OS Ref: 437287, 551603), a width of 1.2 metres.
- **Footpath V – W – X – Y – M**  
 Commencing at point V (OS Ref: 437370, 551879), running in a southerly direction for a distance of 37.3 metres to point W (OS Ref: 437360, 551843), continuing in a southerly direction for a distance of 14.5 metres to point X (OS Ref: 437361, 551829), continuing in a southerly direction for a distance of 65.2 metres to point Y (OS Ref: 437381, 551767), then in a south-easterly direction for a distance of 9.2 metres to point M (OS Ref: 437387, 551761), a width of 1.2 metres.

- Footpath K – X**  
Commencing at point K (OS Ref: 437299, 551785), running in a north-easterly direction for a distance of 77.6 metres to point X (OS Ref: 437361, 551829), a width of 1.2 metres.
- Footpath L – Y – Z – AA**  
Commencing at point L (OS Ref: 437358, 551764), running in an easterly direction for a distance of 23.6 metres to point Y (OS Ref: 437381, 551767), continuing in an easterly direction for a distance of 56.7 metres to point Z (OS Ref: 437437, 551771), continuing in an easterly direction for a distance of 160.9 metres to point AA (OS Ref: 437589, 551806), a width of 1.2 metres.
- Footpath M – BB – CC – DD – O**  
Commencing at point M (OS Ref: 437387, 551761), running in an easterly direction for a distance of 42.7 metres to point BB (OS Ref: 437430, 551763), continuing in an easterly direction for a distance of 153.8 metres to point CC (OS Ref: 437579, 551797), continuing in an easterly direction for a distance of 59.1 metres to point DD (OS Ref: 437637, 551802), then a south-easterly direction for a distance of 32.5 metres to point O (OS Ref: 437261, 551814), a width of 1.2 metres.
- Footpath R – W – EE – FF**  
Commencing at point R (OS Ref: 437350, 551844), running in an easterly direction for a distance of 9.9 metres to point W (OS Ref: 437360, 551843), then north-easterly direction for a distance of 229.0 metres to point EE (OS Ref: 437590, 551928), then north-westerly direction for a distance of 36.6 metres to point FF (OS Ref: 437549, 551955), a width of 1.2 metres.
- Footpath GG – EE – HH – AA – CC**  
Commencing at point GG (OS Ref: 437574, 551946), running in a south-westerly direction for a distance of 18.9 metres to point EE (OS Ref: 437590, 551928), then southerly direction for a distance of 94.9 metres to point HH (OS Ref: 437606, 551842), then south-westerly direction for a distance of 41.0 metres to point AA (OS Ref: 437589, 551806), continuing in a south-westerly direction for a distance of 13.4 metres to point CC (OS Ref: 437579, 551797) a width of 1.2 metres.
- Footpath GG – II – HH – DD**  
Commencing at point GG (OS Ref: 437574, 551946), running in a southerly direction for a distance of 12.8 metres to point II (OS Ref: 437583, 551936), then southerly direction for a distance of 100.5 metres to point HH (OS Ref: 437606, 551842), then south-easterly direction for a distance of 56.9 metres to point DD (OS Ref: 437637, 551802), a width of 1.2 metres.
- Footpath DD – HH**  
Commencing at point DD (OS Ref: 437637, 551802), running in a north-westerly direction for a distance of 55.3 metres to point HH (OS Ref: 437606, 551842), a width of 1.2 metres.

- **Footpath II – JJ**  
 Commencing at point II (OS Ref: 437583, 551936), running in a north-easterly direction for a distance of 29.5 metres to point JJ (OS Ref: 437608, 551950), a width of 1.2 metres.
- **Footpath KK – LL – MM – NN**  
 Commencing at point KK (OS Ref: 437314, 551425), running in a north-easterly direction for a distance of 15.2 metres to point LL (OS Ref: 437320, 551438), continuing in a north-easterly direction for a distance of 87.8 metres to point MM (OS Ref: 437364, 551510), then an easterly direction for a distance of 602.7 metres to point NN (OS Ref: 437923, 551538), a width of 1.2 metres.
- **Footpath LL – OO**  
 Commencing at point LL (OS Ref: 437320, 551438), running in a north-easterly direction for a distance of 27.0 metres to point OO (OS Ref: 437589, 551986), a width of 1.2 metres.
- **Footpath J – KK**  
 Commencing at point J (OS Ref: 437281, 551814), running in a south-easterly direction for a distance of 425.3 metres to point KK (OS Ref: 437314, 551425), a width of 1.2 metres.
- **Footpath KK – U – PP – QQ – N – BB – Z**  
 Commencing at point KK (OS Ref: 437314, 551425), running in a northerly direction for a distance of 189.1 metres to point U (OS Ref: 437287, 551603), then north-easterly direction for a distance of 126.9 metres to point PP (OS Ref: 437356, 551707), then easterly direction for a distance of 35.0 metres to point QQ (OS Ref: 437390, 551706), then north-easterly direction for a distance of 52.4 metres to point N (OS Ref: 437419, 551749), continuing in a north-easterly direction for a distance of 18.1 metres to point BB (OS Ref: 437430, 551763), continuing in a north-easterly direction for a distance of 10.5 metres to point Z (OS Ref: 437437, 551771), a width of 1.2 metres.
- **Footpath KK – RR – SS – TT**  
 Commencing at point KK (OS Ref: 437314, 551425), running in a north-westerly direction for a distance of 262.3 metres to point RR (OS Ref: 437076, 551535), continuing in a north-westerly direction for a distance of 161.8 metres to point SS (OS Ref: 436929, 551603), then northerly direction for a distance of 421.1 metres to point TT (OS Ref: 436833, 552012), a width of 1.2 metres.
- **Footpath RR – UU**  
 Commencing at point RR (OS Ref: 437076, 551535), running in a north-westerly direction for a distance of 65.5 metres to point UU (OS Ref: 437034, 551585), a width of 1.2 metres.

Dated 15<sup>th</sup> December 2016

**THE SEAL of THE COUNCIL** )  
**OF THE CITY OF SUNDERLAND** )  
was hereunto affixed in the )  
presence of:- )



Authorised Signatory

62229A SEAL NO.

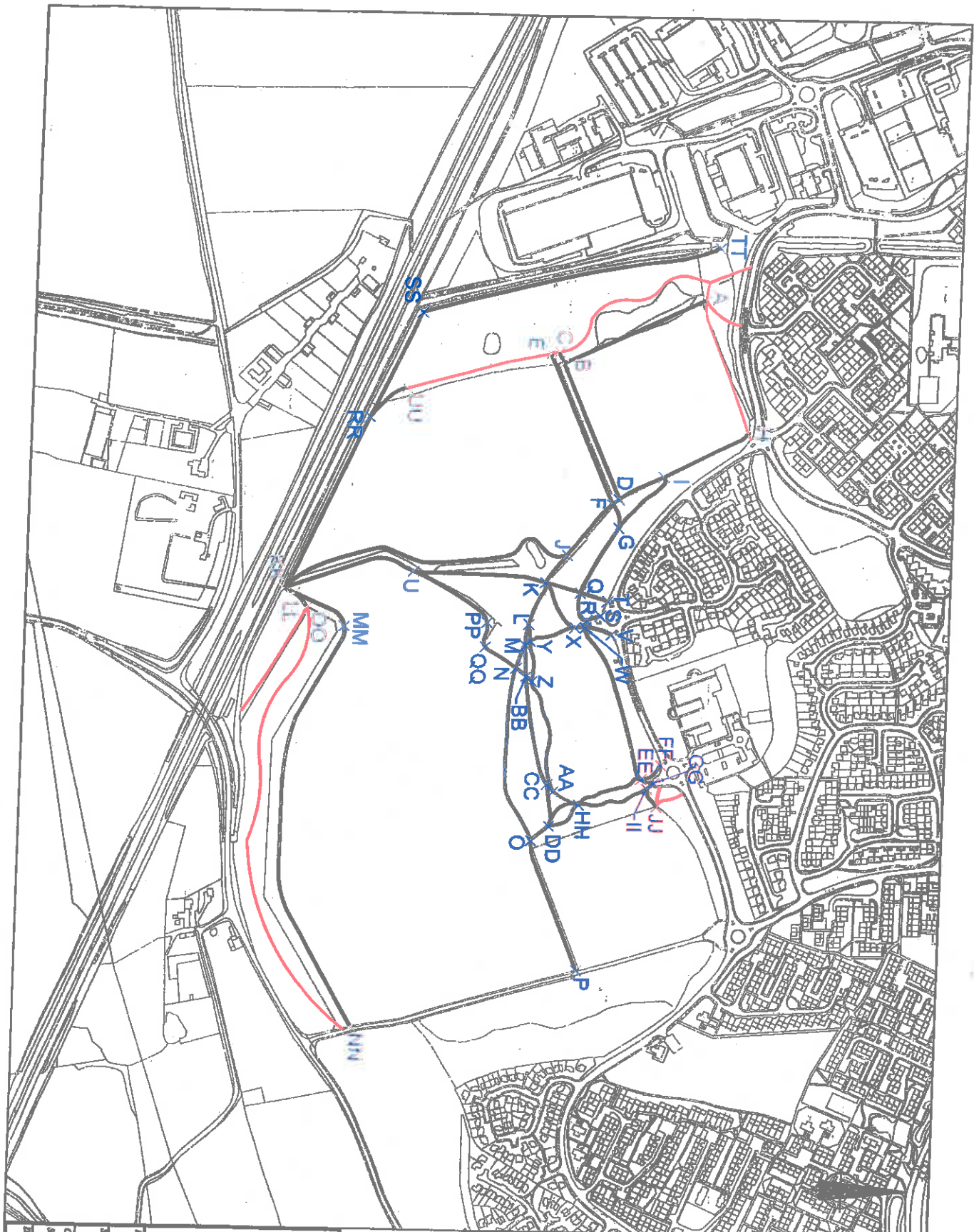

**Key:**  
 — Footpath to be extinguished  
 — Footpath to be retained

*2018*

100009 A SGNL NO  
 AUTHORISED SIGNATORY

For information purposes only. No further action to be made by the Council in relation to this document. This document is for information purposes only. It is not intended to constitute an offer of any financial product or service. It is not intended to be relied upon as a basis for any investment decision. It is not intended to be used for any other purpose. It is not intended to be used for any other purpose. It is not intended to be used for any other purpose.

**Sunderland City Council**

Economy and Place Directorate  
 Jack Crawford House  
 Sunderland SR2 8QR  
 Telephone: 0191 520 5655  
 Fax: 0191 553 1460  
 Web: [www.sunderland.gov.uk](http://www.sunderland.gov.uk)

Project: EXTINGUISHMENT OF HIGHWAY  
 S258 TCPA 1990

Site: VARIOUS FOOTPATHS SOUTH OF  
 MOORSIDE RD & WEYMOUTH RD

Checker: P10enham Date: November 2016

Drawing No: SDO48294/03

In pursuance of their powers under Section 258 of the Town and Country Planning Act 1990 and of all other powers them enabling in that behalf THE COUNCIL OF THE CITY OF SUNDERLAND hereby confirm the foregoing Order the \_\_\_\_\_ day of \_\_\_\_\_

**THE SEAL of THE COUNCIL** )  
**OF THE CITY OF SUNDERLAND** )  
was hereunto affixed in the )  
presence of:- )

Authorised Signatory