

Foreward

ASBESTOS SURVEY REPORT FOR SPRINGWELL SCHOOL, WILTSHIRE WAY, HARTLEPOOL, TS26 0TB.

I have enclosed for your information and retention the most recent asbestos survey (Management) which applies to the property stated above. The purpose of the survey is to identify as far as possible, the materials containing asbestos fibres in your property.

The attached report is divided in sections so as to give as much information as possible, a basic reference section for use by premises managers and a more detailed report for use by contractors on site etc.

Plan of the Building and Sample Locations

This contains a plan of the building and identifies where asbestos samples have been taken from.

Photographs of Areas Sampled

This section contains photographs of all the areas where samples were taken. These photographs can be used when carrying out the periodic inspections to see if there has been any change or deterioration in its condition.

Survey Information

This section contains the survey information as printed from the central database held at Land and Property. It describes the type of asbestos present, its location, condition etc. Contractors should be shown this section along with the others when they are shown the register prior to starting any work.

Priority Risk Assessments

This section contains assessments which have been created using information from the survey and information on your property. This assessment helps to determine how often periodic checks on any asbestos need to be carried out by your Samo.

5 Simple Steps to Asbestos Management

This section details procedures for managing asbestos in your property. It gives guidance on the register, the inspections, any planned work and what to do when contractors arrive on site.

Commonly asked Questions

This section covers questions most commonly asked and can be referred to as/when the need arises.

The building has been surveyed as comprehensively as possible, all potentially fibrous materials have been examined and where necessary analysed by competent UKAS accredited analysts and the findings of both recorded in the report.

This report is an important document and must be referred to before any building works are carried out. The report must be kept with your handbook and the checklists completed on a regular basis. You will be reminded when your specific checklists are due for submission.

Information for Employees Working in Premises where Asbestos Containing Materials Exist.

Asbestos is made up of fibrous materials, which are flexible, mechanically strong and resistant to stretching, heat and chemicals. As a consequence asbestos has been used extensively in buildings. Examples of asbestos containing materials found in buildings include exterior asbestos cement cladding; gutters and pipes; fireproof sprays on structural steel joists; insulation boards in service ducts and wall partitions; ceiling and floor tiles and pipe and boiler lagging.

Asbestos containing products can produce very small fibrous dust particles, which can not be seen by the naked eye. It is only when these fibres become airborne, due to damage, deterioration, disturbance etc, that there is a risk to health.

If asbestos is maintained in good condition and is not disturbed or damaged it does not pose a health risk.

The authority has a management system for ensuring that you are not exposed to asbestos containing materials that are in poor condition and may pose a health risk. This system is based on sound principals laid down by legislation and associated codes of practice and guidance.

It is not appropriate simply to remove all asbestos containing materials in buildings. Asbestos materials that are sound, undamaged and not releasing dust should be left alone. Any disturbance to such materials, however carefully controlled, will release fibres and be counter-productive.

Within the building you occupy, your department has nominated a Site Asbestos Monitoring Officer (SAMO). This individual is responsible for inspecting the asbestos containing materials to ensure they are not in a dangerous condition. Should you have any concerns about suspect materials within your premises you should contact the SAMO.

Restrictions on use, distribution and publication of the report

We accept no responsibility or liability for the consequences of this document being used for purpose other than for which it was commissioned.

To the extent that the document is based on the information available at the time of writing, Sunderland City Council accepts no liability for any consequences should this report be used for any other purpose

If you require any further information regarding the report or its application please contact Caroline Bage, Asbestos Manager on Tel: 07557 938966.

Yours sincerely,

Paul Davies
Assistant Director of Assurance and Property Services

Sunderland
City Council

Sunderland City Council

*Control of Asbestos
Regulations 2012*

Asbestos Register for

Springwell School, Wiltshire Way, Hartlepool



UPRN: - J171962

TF Ref:

Location of register:-

Premises Manager / Samo: - Tenant

Date: 26 May 2026

Contact Numbers List: -

Caroline Bage Asbestos Manager – 07557 938966

Contents

	<u>Section</u>
• Plan of building and sample locations	1
• Photographs of areas sampled	2
• Survey information	3
• Asbestos Management Plan, Priority Assessments,	4
• Contacts Form, Code of Practice	4
• 5 Simple Steps of Asbestos Management	5
• Commonly asked questions	6

Appendices

• Form 1 – Visitor Register	7
• Form 2 – Periodic Return Checklist and Schedule	8
• Form 3 – Works Notification Form	9
• Form 4 – Registration of All Disturbances	10
• Form 5 – Training Records	11

Plan of Building and Samples Location

Item No.	Sample Ref.	Area Sampled	Location Name	Inspection Frequency
1.	As PZ000002	Roof Lining Old	Ground Floor Room 033 – Female Toilets	No Risk
2.	PZ000002	Roof Lining Old	Roof Void Room L001 – Loft space above library 032A	No Risk
3.	PZ000003	Undercloak	External E1	No Risk
4.	PZ000004	Canopy Ceiling	External E1	No Risk
5.	PZ000005	Window putty/seal old mastic around doors and windows outside rooms 058/059	External E1	Very Low Risk – To be checked on a 12 monthly basis
6.	PZ000006	Undercloak outside room 063	External E1	No Risk
7.	As PZ000006	Undercloak outside room 070a	External E1	No Risk
8.	PZ000007	Roof sheet claddings	External E2	No Risk
9.	PZ000008	Pipework gaskets	External 089 – Meter Cupboard	Very Low Risk – To be checked on a 12 monthly basis
10.	PZ000009	Roof Lining	External 090 Garage block B	No Risk
11.	PZ000010	Undercloak	External 090 Garage block B	No Risk
12.	RN000235	Floor adhesive	Kitchen Cookery Room G/002	No Risk
13.	RN000236	Undersink Mat	Kitchen Cookery Room G/002	No Risk
14.	RN000237	Floor adhesive	Room speech and language therapy G/003	No Risk
15.	RN000238	Door seal/gasket	External E/001	No Risk
16.	TL001143	Under sink mat	Kitchen G/021	No Risk
17.	TL001144	Floor – tile joining material	Kitchen G/021	No Risk
18.	TL001148	Wall Skirting	Caretakers Room G/082	No Risk
19.	TL001145	Door - seal/Gasket door to kitchen	External E/01	Very Low Risk – To be checked on a 12 monthly basis
20.	TL001146	Wall remnants around metal door	External E/01	No Risk

Please note the survey carried out was non-intrusive and any areas not listed above may not have been accessed or had samples taken, should major refurbishment be planned for the property, further investigation will be required.

Photographs of Areas Sampled

Item 1 Ref: As PZ000002



The old roof lining in the ground floor female toilets (Room 033) does not contain asbestos.

Item 2 Ref: PZ000002

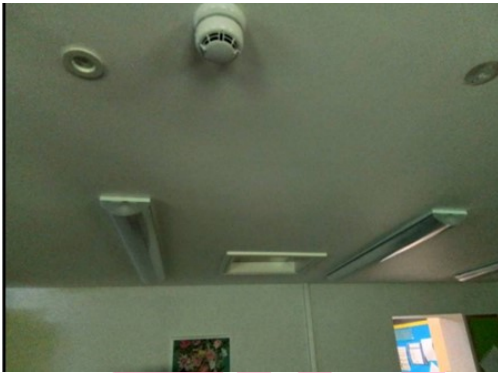

The old roof lining in roof void in the loft space above the library (Room 032a) does not contain asbestos.

Item 3 Ref: PZ000003



The undercloak (External E1) does not contain asbestos.

Photographs of Areas Sampled (Cont)

Item 4 Ref: PZ000004



The canopy ceiling (External E1) does not contain asbestos.

Item 5 Ref: PZ000005



The window putty/seal old mastic around doors and windows and outside rooms (External E1) does contain asbestos.

Any change in its appearance should be recorded and passed to Property Services.

Item 6 Ref: PZ000006

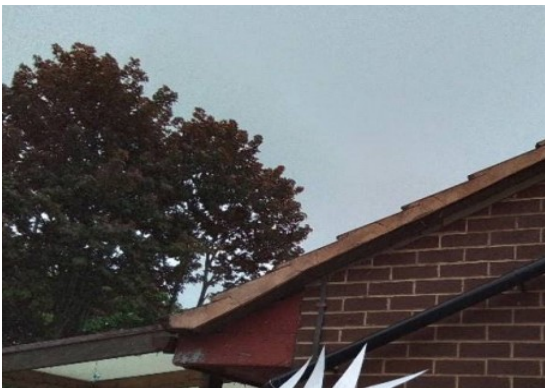

The undercloak outside room 063 (External E1) does not contain asbestos.

Photographs of Areas Sampled (Cont)

Item 7 Ref: As PZ000006



The undercloak outside room 070a (External E1) does not contain asbestos.

Item 8 Ref: PZ000007



The roof sheet cladding (External E2) does not contain asbestos.

Item 9 Ref: PZ000008



The pipework gaskets in the meter cupboard (External 089) does contain asbestos.

Any change in its appearance should be recorded and passed to Property Services.

Photographs of Areas Sampled (Cont)

Item 10 Ref: PZ000009



The roof lining to Garage block B (external 090) does not contain asbestos.

Item 11 Ref: PZ000010



The undercloak to Garage block B (external 090) does not contain asbestos.

Item 12 Ref: RN000235



The floor adhesive in the Kitchen Cookery Room (G/002) does not contain asbestos.

Photographs of Areas Sampled (Cont)

Item 13 Ref: RN000236



The under sink mat in the Kitchen Cookery Room (G/002) does not contain asbestos.

Item 14 Ref: RN000237



The floor adhesive in the Speech and language therapy room (G/003) does not contain asbestos.

Item 15 Ref: RN000238



The door seal/gasket externally (E/001) does not contain asbestos.

Photographs of Areas Sampled (Cont)

Item 16 Ref: TL001143



The under sink mat in the Kitchen (G/021) does not contain asbestos.

Item 17 Ref: TL001144



The tile joining material to the floor in the Kitchen (G/021) does not contain asbestos.

Item 18 Ref: TL001148

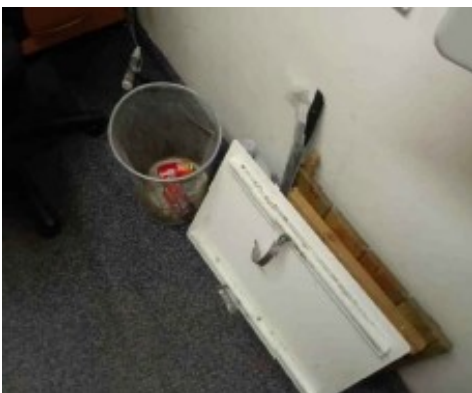

The wall skirting in the Caretakers Room G/082) does not contain asbestos.

Photographs of Areas Sampled (Cont)

Item 19 Ref: TL001145

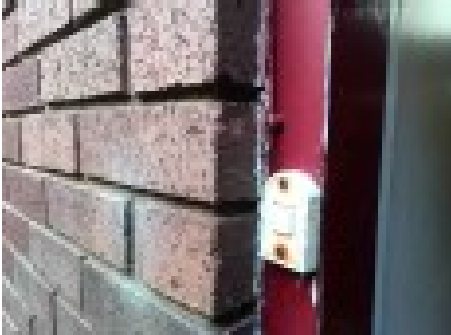

The door seal/gasket door to kitchen (External E/01) does contain asbestos.

Any change in appearance should be reported to Property Services.

Item 20 Ref: TL001146



The wall remnants around metal door (external E/01) does not contain asbestos.

Five Simple Steps to Asbestos Management

Each property has a nominated site asbestos monitoring officer (SAMO). The SAMO is responsible for maintaining this register and ensuring all necessary personnel are aware of the register including all maintenance, construction and service installers; undertaking periodic inspections and liaising with the Departmental Asbestos Co-ordinator and the Asbestos Manager in Property Services as necessary.

The SAMO's role is very important but this guide is hoped to ensure the requirements are easy and simple to follow.

Step 1 – Receiving the Register

The SAMO is the tenant.

And the person is responsible for the register, where it is located and that it is kept up to date.

The register contains a plan of the premises and a photographic schedule of where the asbestos is and what risk is associated.

The SAMO must make all employees aware of the locations and should let any contractors entering the building view the register before any work is started.

Step 2 – Periodic Inspections

The SAMO must look at the locations photographed and compare the asbestos now to when the photograph was taken and complete the checklist attached (Form 2).

The checklists are to be completed periodically in accordance with the schedule attached.

Should the SAMO come across some asbestos which has been disturbed, whether during refurbishment works or during the normal course of wear and tear, they should complete Form 4 as far as possible and contact Property Services for advice and remedial action.

In the meantime, they should ensure that access to the area containing the disturbed or damaged asbestos is prohibited until Property Services has made recommendations.

Step 3 – Planned Work

All planned works that may disturb or danger any asbestos indicated, should be reported to Property Services using form 3 at least 21 days before the work is due to commence.

Step 4 – Contractors on Site

If a contractor arrives on site, the SAMO must :

- a. Make sure they read/view the register
- b. Get contractor to sign register to say he has read it (Form1).
- c. Get confirmation from the contractor that proposed works will not disturb any asbestos areas.
- d. If area is disturbed that was not identified in Register, advise Property Services immediately and complete Form 4.

Step 5 – Monitoring the Register

On completion of work get contractor to sign to say they didn't disturb any areas.

If alterations have occurred details should be forwarded to Property Services.

If you, as SAMO, are to leave your post, please notify your Departmental Co-ordinator to appoint another person and notify Property Services and the front of your register.

In the event of an exposure of asbestos, please refer to your site specific emergency procedures. However, as a minimum:

- Seal the area off completely. (Lock the area off if possible and post a notice on the door, "No access - Contact ")
- If there is any air movement systems within the premises, shut it off.
- Contact the Asbestos Manager on 07557 938966 immediately. Who will arrange for any remedial works / air monitoring.
- Start to complete the "Registration of Disturbances" form, which is in your register (Section 10 in the new style register).

Once the remedial works have been carried out and a clear air test certificate has been issued. Access to the area can be re-opened.

In the event that you are unable to contact the Asbestos Manager, please contact the Civic Centre on 520 5555 and ask for assistance from a building surveyor. Out of hours ring the City Alarm and Emergency Control room on 553 1999.

Central Safety can be contacted on 561 2311.

In the event of a fire (or drill), the asbestos register must be taken outside to show the emergency services.

Commonly Asked Questions.

- **How often should SAMO's undertake inspections of asbestos containing materials?**
The Asbestos Manager will inform the SAMO of how often the inspections should be undertaken.
- **What should a SAMO do if the asbestos containing materials are disturbed or damaged?**
The SAMO should prohibit access to the areas until the Asbestos Manager in Property Services has been contacted and given recommendations.
- **Can employees put up decorations onto asbestos containing materials?**
No decorations should be attached to asbestos containing materials. However, it is understood that some decoration is already attached to asbestos containing materials and these should be left in place.
- **Can a room with asbestos containing materials in the ceiling and wall be painted?**
Yes, as long as the material is not rubbed or sanded down, as this may result in the release of asbestos fibres.
- **Why isn't all asbestos containing materials removed from buildings?**
Because it is safer to leave asbestos containing materials in good condition in buildings. Removing the materials will result in a greater risk to health because of the consequential release of fibres.
- **When will asbestos containing material be removed from my building?**
Asbestos containing materials will be removed if work involves the disturbance of the material e.g. during the refurbishment or dismantling of part of the building or structure.
- **What should a SAMO do if he/she has had no training in use of the register?**
The SAMO should ring the Departmental Co-ordinator who will arrange training.

INSPECTION SCHEDULE

FORM 2

Item No.	Area Sampled	Location Name	Inspection Frequency	Date of Return	Condition Same/change	Action Required Y/N	Comments
1.	Roof Lining Old	Ground Floor Room 033 – Female Toilets	No Risk	N/A			
2.	Roof Lining Old	Roof Void Room L001 – Loft space above library 032A	No Risk	N/A			
3.	Undercloak	External E1	No Risk	N/A			
4.	Canopy Ceiling	External E1	No Risk	N/A			
5.	Window putty/seal old mastic around doors and windows outside rooms 058/059	External E1	Very Low Risk – To be checked on a 12 monthly basis	20/12/2026			
6.	Undercloak outside room 063	External E1	No Risk	N/A			
7.	Undercloak outside room 070a	External E1	No Risk	N/A			
8.	Roof sheet claddings	External E2	No Risk	N/A			
9.	Pipework gaskets	External 089 – Meter Cupboard	Very Low Risk – To be checked on a 12 monthly basis	20/12/2026			
10.	Roof Lining	External 090 Garage block B	No Risk	N/A			
11.	Undercloak	External 090 Garage block B	No Risk	N/A			
12.	Floor adhesive	Kitchen Cookery Room G/002	No Risk	N/A			
13.	Undersink Mat	Kitchen Cookery Room G/002	No Risk	N/A			
14.	Floor adhesive	Room speech and language therapy	No Risk	N/A			

		G/003					
15.	Door seal/gasket	External E/001	No Risk	N/A			
16.	Under sink mat	Kitchen G/21	No Risk	N/A			
17.	Floor – tile joining material	Kitchen G/21	No Risk	N/A			
18.	Wall Skirting	Caretakers Room G/082	No Risk	N/A			
19.	Door - seal/Gasket door to kitchen	External E/01	Very Low Risk – To be checked on a 12 monthly basis	20/12/2026			
20.	Wall remnants around metal door	External E/01	No Risk	N/A			

Sunderland City Council

Good Practice Guidance:

- Take photographs of ACMs for each inspection and store for future reference
- Compare previous photographs with current condition state to determine whether there has been any deterioration the last inspection
- Replace missing/damaged asbestos labels/stickers

Comments:

Sunderland
City Council

School/Site:	
Date of inspection:	
Inspected by (signature):	
Print Name:	

Sunderland
City Council